

# HSDM OFFICE OF RESEARCH BULLETIN

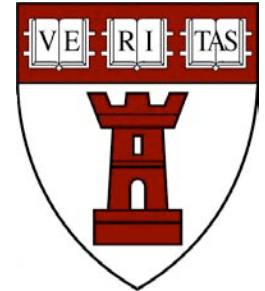

Jul/Aug 2005

## GRANTS & AWARDS:

### SHIGEMI NAGAI, PHD, DDS

Instructor in Restorative Dentistry and Biomaterials Sciences received a grant from the ITI Foundation for her project, Optical Effects of a Modified Implant Neck Color on Peri-Implant Soft Tissue Esthetics. Dr. Nagai practices in the Harvard Dental Center Faculty Group Practice and has a lab in the REB 3<sup>rd</sup> floor.

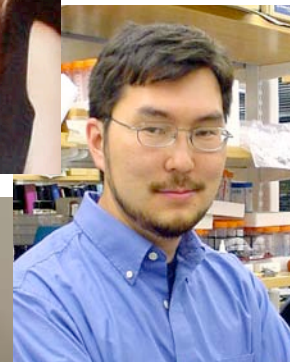

### ARKHAT ABZHANOV, PHD

Assistant Professor in Developmental Biology received a Fellowship from The Eleanor and Miles Shore Scholars in Medicine Program. The Program was established to help junior faculty at the point in their careers when they must teach, do research, compete for grants, and publish at the same time they may be assuming increased family or other responsibilities. The Abzhanov Lab studies how differentiation of the cranial neural crest cells into chondrocytes and osteocytes occurs on the cellular and tissue level. They are also interested in the mechanisms by which the processes evolve to produce distinct craniofacial morphologies. Dr. Abzhanov's Lab is in the REB 5<sup>th</sup> floor.



### MARTIN NWEEIA, DMD

Clinical Instructor in Restorative Dentistry and Biomaterials Sciences received a grant from The National Geographic Society to fund his 2005 expedition to the Baffin Island in the Arctic Bay for his Narwhal Tooth field research. The project is jointly-sponsored by Dr. Weber and the Restorative Dentistry and Biomaterials Sciences Department as well as the Smithsonian Foundation.

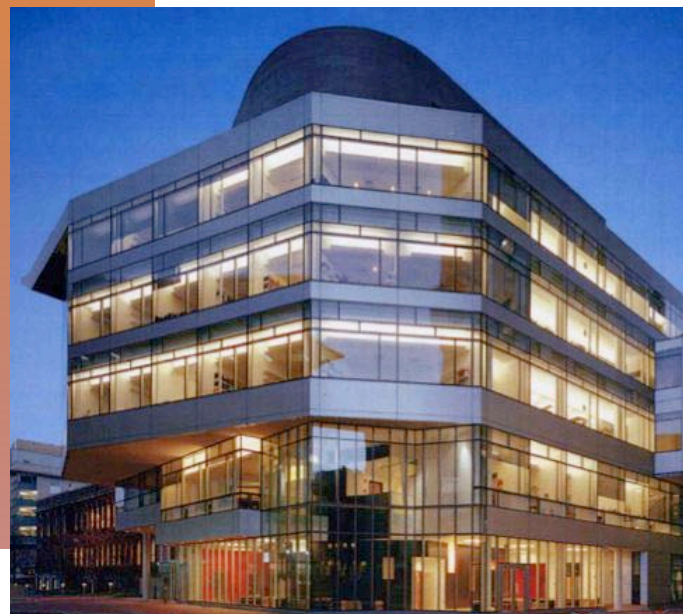

Rothman Partners Architects

# RECENT PUBLICATIONS:

- Abid MR, Razzaque MS, Taguchi T. Oxidative stress in renal pathophysiology. *Contributions to Nephrology* 2005;148:135-153.
- Albertson RC, Yelick PC. Roles for fgf8 signaling in left-right patterning of the visceral organs and craniofacial skeleton. *Developmental Biology* 2005;283(2):310-321.
- Albertson RC, Payne-Ferreira TL, Postlethwait J, Yelick PC. Zebrafish *acvr2a* and *acvr2b* exhibit distinct roles in craniofacial development. *Developmental Dynamics* 2005;233(4):1405-1418.
- Ardekian L, Faquin W, Troulis MJ, Kaban LB, August M. Synovial chondromatosis of the temporomandibular joint: report and analysis of eleven cases. *Journal of Oral and Maxill Surg* 2005;63(7):941-947.
- Edwards PD, Rahbar R, Ferraro NF, Burrows PE, Mulliken JB. Lymphatic malformation of the lingual base and oral floor. *Plastic and Reconstructive Surgery* 2005;115(7):1906-1915.
- Erben RG, Mayer D, Weber K, Jonsson K, Juppner H, Lanske B. Overexpression of Human PHEX Under the Human beta-Actin Promoter Does Not Fully Rescue the Hyp Mouse Phenotype. *Journal of Bone and Mineral Research* 2005;20(7):1149-1160.
- Evans C, Viana G, Anderson N, Giddon D. Tolerance of deviations in eye and mouth position. *Orthodontics and Craniofacial Research* 2005;8(2):75-84.
- Glickman GN, Gluskin AH, Johnson WT, Lin J. The crisis in endodontic education: current perspectives and strategies for change. *Journal of Endodontics* 2005;31(4):255-261.
- Glowacki J, Yates K, Maclean R, Mizuno S. In vitro engineering of cartilage: effects of serum substitutes, TGF-beta, and IL-1 alpha. *Orthodontics Craniofacial Research* 2005;8(3):200-208.
- Hopfer U, Fukai N, Hopfer H, Wolf G, Joyce N, Li E, Olsen BR. Targeted disruption of *Col8a1* and *Col8a2* genes in mice leads to anterior segment abnormalities in the eye. *FASEB J* 2005;19(10):1232-1244.
- Hung HC, Colditz G, Joshupura KJ. The association between tooth loss and the self-reported intake of selected CVD-related nutrients and foods among US women. *Community Dentistry and Oral Epidemiology* 2005;33(3):167-173.
- Janket SJ, Moles DR, Lau J, Needleman I, Niederman R. To the Editor: Caveat for a cumulative meta analysis. *Journal of Dental Research* 2005;84(6):487.
- Joshupura KJ, Ritchie C. Can the relation between tooth loss and chronic disease be explained by socioeconomic status? *European Journal of Epidemiology* 2005;20(3):203-204.
- Kobayashi T, Soegiarto DW, Yang Y, Lanske B, Schipani E, McMahon AP, Kronenberg HM. Indian hedgehog stimulates periarticular chondrocyte differentiation to regulate growth plate length independently of PTHrP. *Journal of Clinical Investigation* 2005;115(7):1734-1742.
- Kolpakova E, Olsen BR. Wnt/beta-Catenin-A canonical tale of cell-fate choice in the vertebrate skeleton. *Developmental Cell* 2005;8(5):626-627.
- Kubota K, Lee DH, Tsuchiya M, Young CS, Everett ET, Martinez-Mier EA, Snead ML, Nguyen L, Urano F, Bartlett JD. Fluoride induces endoplasmic reticulum stress in ameloblasts responsible for dental enamel formation. *Journal of Biological Chemistry* 2005;280(24):23194-202.
- Kwon KR, Sachdeo A, Weber HP. Achieving immediate function with provisional prostheses after implant placement: A clinical report. *Journal of Prosthetic Dentistry* 2005;93(6):514-517.
- Letko E, Papaliadis DN, Papaliadis GN, Daoud YJ, Ahmed AR, Foster CS. Stevens-Johnson syndrome and toxic epidermal necrolysis: a review of the literature. *Annals of Allergy Asthma Immunology* 2005;94(4):419-438.
- Lin LM, Rosenberg PA, Lin J. Do procedural errors cause endodontic treatment failure? *Journal of American Dental Association* 2005;136(2):187-193.
- Marneros AG, Olsen BR. Physiological role of collagen XVIII and endostatin. *FASEB J* 2005;19(7):716-728.
- Nogi T, Yuan YE, Sorocco D, Perez-Tomas R, Levin M. Eye regeneration assay reveals an invariant functional left-right asymmetry in the early bilaterian, *Dugesia japonica*. *Laterality* 2005;10(3):193-205.
- Pibooniyom SO, Treister N, Pitiphat W, Woo SB. Scoring system for monitoring oral lichenoid lesions: a preliminary study. *Oral Surg Oral Med Oral Path Oral Radiol Endod.* 2005;99(6):696-703.
- Razzaque MS, Le VT, Taguchi T. Heat shock protein 47 and renal fibrogenesis. *Contributions to Nephrology* 2005;148:57-69.
- Reece ST, Stride N, Ovendale P, Reed SG, Campos-Neto A. Skin test performed with highly purified *Mycobacterium tuberculosis* recombinant protein triggers tuberculin shock in infected guinea pigs. *Infection and Immunity* 2005;73(6):3301-3306.
- Samet N, Shohat M, Livny A, Weiss EI. A clinical evaluation of fixed partial denture impressions. *J Prosthetic Dentistry* 2005;94(2):112-7.
- Smith DJ, King WF, Rivero J, Taubman MA. Immunological and protective effect of diepitopic subunit dental caries vaccines. *Infection and Immunity* 2005;73:2797-2804.
- Taguchi T, Nazneen A, Abid MR, Razzaque MS. Cisplatin-associated nephrotoxicity and pathological events. *Contribution to Nephrology* 2005;148:107-121.

# STUDENT ACTIVITIES:

---

The Academy of Prosthodontics Foundation has awarded grants to three Harvard School of Dental Medicine Advanced Graduate Prosthodontics students. **DR. AMIT SACHDEO** for his project, Intra-Oral Biofilm Formation. Dr. Sachdeo is working with his mentor, Dr. Sigmund Socransky at The Forsyth Institute. **DR. SEIICHI YAMANO** for his project, Polymeric Gene Discovery of VEGF and BMP-2 for Bone Regeneration. Dr. Yamano is working with his mentor, Dr. David Mooney in the Division of Engineering and Applied Sciences at Harvard University. **DR. CORTINO SUKOTJO** for his project, Osteoclastic Phenotypic Characterization on Different Titanium Implant Surface Topographies. Dr. Sukotjo is now a Faculty member in Restorative Dentistry and Biomaterials Sciences at HSDM.

Congratulations to **ELIZABETH CHANESON, CAROLINE LAURENT (06)** (Student Directors), and **DR. JARSHEN LIN** (Faculty Advisor). They just won the first place of The 2005 Community Preventive Dentistry Award of ADA through their efforts of Project Bridge, the oral health care programs for homeless teens .

The Community Preventive Dentistry Award was established in 1972 by the ADA and Johnson & Johnson Oral Health Co. to recognize outstanding community preventive dentistry programs. In the past three years, under the leadership of Dr. Jarshen Lin, Project Bridge also won the First Place of Pre-doctoral Student Merit Award for Outstanding Achievement in Preventive and Community Dentistry (The American Association of Public Health's Dentistry), Excellence in Dental Education and Service Award (American Dental Education Association), and the 2nd place winner of the U.S. Department of Health and Human Services Secretary's Award.



## MMSc STUDENT RESEARCH REQUIREMENT CHANGES

In lieu of preparing a thesis proposal, MMSc students are now required to write an NIH grant proposal (scientific portion only). This proposal must be completed within 15 months of starting their program. Students will then defend these proposals in front of 2-3 faculty members selected by the Office of Research. Please note, students will have the opportunity to attend a new course, "How to write a competitive NIH grant application" that will be offered quarterly by Drs. Olsen, Howell, Douglass and Rosen. Students will also receive handouts and sample grant applications from the Office of Research.

**PLEASE STAY TUNED FOR ADDITIONAL INFORMATION!**

# GRANTS & AWARDS

(continued):

## DR. KAUMUDI JOSHIPURA

Associate Professor in Oral Health Policy and Epidemiology received a grant from NIH-NIDCR for, Mentoring and Research in Oral Epidemiology.

Dr. Joshipura's career has emphasized patient oriented research in oral epidemiology ranging from evaluation of risk factors, to mechanistic studies evaluating pathways, to clinical trials. Her ongoing funded research focuses on the relationships between oral conditions, inflammatory markers, nutrition and specific cardiovascular diseases. She has expanded this work to include additional cardiovascular endpoints and pregnancy outcomes, and is starting to work in diabetes. She plans to gain additional research skills by learning molecular and genetic epidemiology, which would substantially enhance her research career.

## HUMAN STUDIES/IRB REMINDERS:

- ✓ The HMS/HSDM Committee on Human Studies meets on the last Tuesday of every month. Please submit your applications at least 5 business days prior to the last Tuesday.
- ✓ Protocols (new and continuing review) and protocol changes take approximately 6 weeks to process, from receipt of the application through approval.
- ✓ Many applications take longer to process due to incomplete information - please be sure to answer each question on the application, and include all requested study documents, as this will streamline the process considerably.
- ✓ If you are still engaged in study-related activities (such as data collection or data analysis), you must file a Continuing Review application.
- ✓ If you are completely finished with study-related activities (including data analysis), you must file a Request for File Closure with this office as soon as possible (and before your study expires).
- ✓ Human Studies/IRB/HIPAA Questions? Please call Dawn DeCosta in the HSDM Office of Research at 617-432-1121; or Pam Greiff in the HMS/HSDM Office for Research Subject Protection at 617-432-2597.

### QUESTIONS FOR THE OFFICE OF RESEARCH?

**BJORN OLSEN**, *Dean for Research*  
REB 409; 617-432-1874; bjorn\_olsen@hms.harvard.edu

**DAWN DECOSTA**, *Assistant Director of Research*  
REB 508; 617-432-1121; dawn\_decosta@hsdm.harvard.edu

**CATHERINE HAYES**, *Director of Predoctoral Research*  
REB 506; 617-432-3507; catherine\_hayes@hsdm.harvard.edu

**JIM MCBRIDE**, *Director of Core Laboratories*  
REB 408; 617-432-5613; jim\_mcbride@hsdm.harvard.edu

**JENNIFER MOLTONI**, *Staff Assistant*  
REB 509; 617-432-5743; jennifer\_moltoni@hsdm.harvard.edu

**ANNIE STUDDARD**, *Lab Aide*  
REB 411; 617-432-5847; anna\_studdard@hsdm.harvard.edu

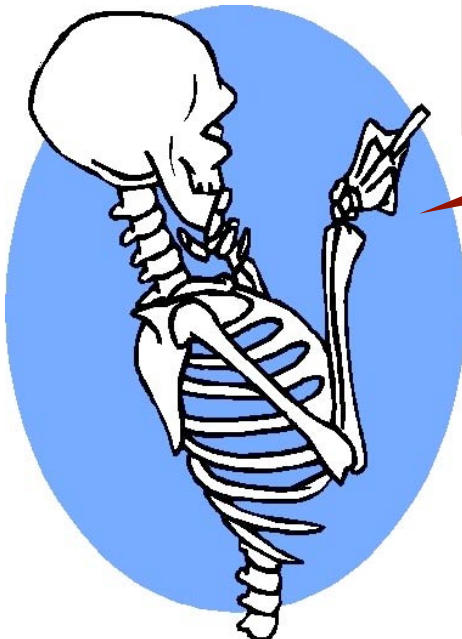

## SAVE THE DATE:

### April 7, 2006

### Harvard Forsyth Research Symposium

### BONE & TEETH: DEVELOPMENT, GROWTH AND REPAIR